

4

3

2

1

- NOTES:
- 1. APPLICABLE STANDARDS/SPECIFICATIONS:
ASME Y14.5M-1994, DIMENSIONING AND TOLERANCING
ASME Y14.38-1999, ABBREVIATIONS
 - 2. COMPONENT OR ITEM TO BE COMPLIANT WITH THE MOST
CURRENT REVISION OF THE RoHS / Wee DIRECTIVE FOR
THE REDUCTION OF HAZARDOUS SUBSTANCES AND MATERIALS.

REV	DATE	EC #	ZONE	DESCRIPTION	DRAWN	CKD
A	2007-07-27			ORIGINATED	DC	
A1	2007-09-10	1288		DESIGN UPDATE	DC	
B	2020-06-29			REDRAWN IN SW	NR	

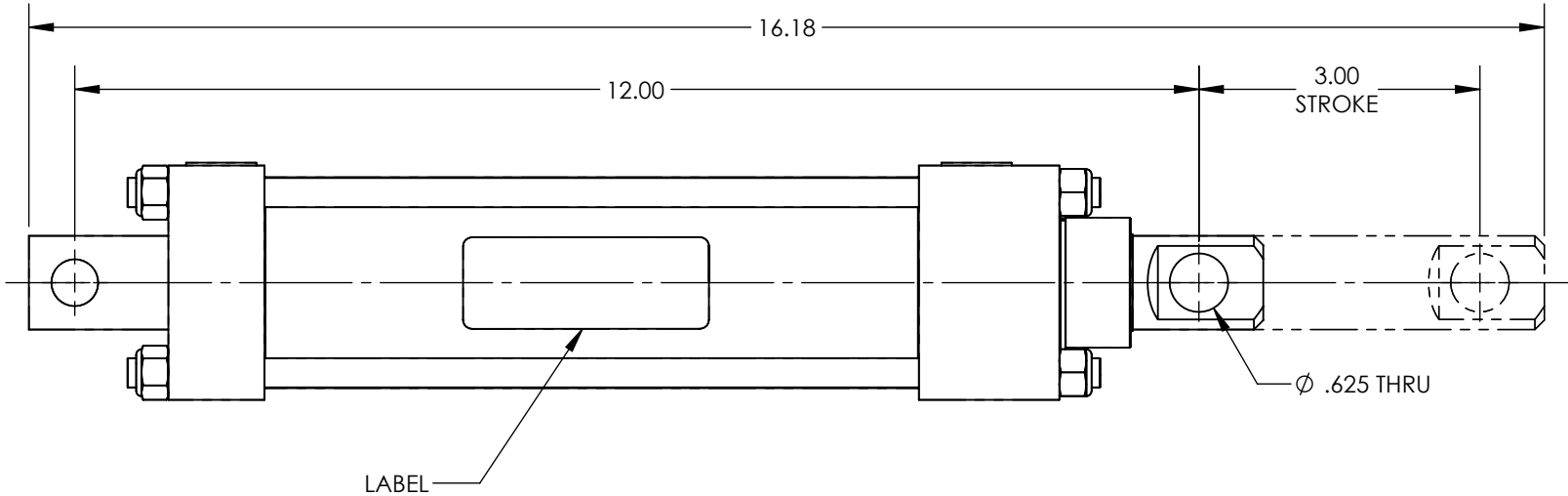
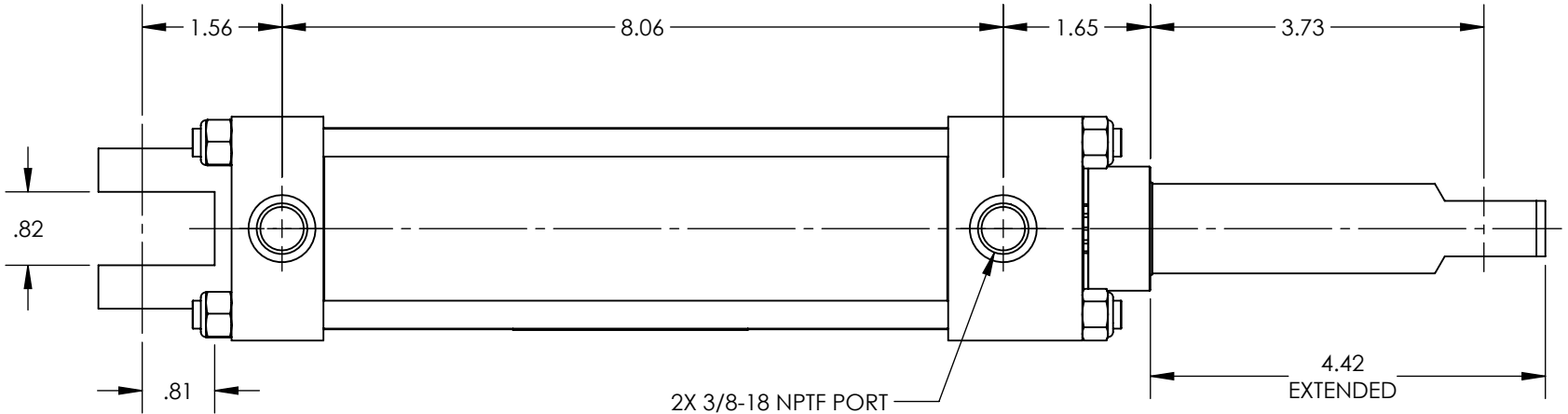

FUNCTION	2.0" BORE X 3.0 STROKE, SPRING EXT., DOUBLE ACTING CYL.
MECHANICAL MATERIALS	UHMW WEAR BAND, STAINLESS STEEL TIE RODS, ALUMINUM PISTON & END CAP, HEAVY DUTY BRASS ROD BEARING, 1" DIAMETER STAINLESS STEEL PISTON ROD, HARD COAT ANODIZED ALUMINUM CYLINDER
SEALS	LOW TEMP. NITRILE, LOW COMP. SET POLYURETHANE
FASTENERS	N/A
MTG STYLE	CLEVIS
ASSY LUBRICATION	HEAVY TRANSPORT SILICONE
FLOW	N/A
TEMP	-40 TO 180°F
FILTRATION	40 MICRON
SYSTEM LUBRICATION REQ'D	N/A
PRESSURE RANGE	MIN. 5psi, MAX. 150psi PNEUMATIC, MAX. 200psi HYDRAULIC NON-SHOCK
LEAK	N/A
ELECTRICAL VOLTAGE	N/A
CURRENT	N/A

CUSTOMER PRINT

NOTE: PART MUST BE CLEAN AND BURR FREE
MFG TOLERANCES UNLESS OTHERWISE NOTED:
ALL UNITS ARE INCHES
(2) DECIMAL PLACES: ±.01
(3) DECIMAL PLACES: ±.005
ANGLES: ±.5°
BREAK ALL EDGES .005/.015 X 45°
MACHINED SURFACES TO BE 63 RMS
CRITICAL CHARACTERISTIC - CONTROL
PLAN REQUIRED



AIRman
PRODUCTS

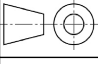

Third Angle
Projection

CONFIDENTIAL: THIS DRAWING OR
ANY PART THEREOF IS PROPRIETARY
AND MAY NOT BE REPRODUCED OR
COPIED WITHOUT WRITTEN CONSENT
OF AIRMAN PRODUCTS

DRAWN BY	DC	DESCRIPTION
DRAWN DATE	2007-07-27	CYLINDER, 2.0 X 3.0 STROKE, SPRING EXT., DOUBLE ACTING
DRAWING SIZE	B	
MATERIAL	SEE NOTES	PART NUMBER
SCALE	1:2	B3000-424
SHEET #	1 OF 1	

4

3

2

1